

OLD
BEDFORD CEMETERY.
SCALE - 1/4" = 1'-0"

SEE SECTION H
DRAWING #8

- SYMBOLS -

↑ NO HEAD OR FOOT STONES	↑ INFANTS GRAVE (1/2 SIZE)
↑ WITH HEAD STONE ONLY	↑ MOTHER AND INFANT IN SAME GRAVE
↑ WITH FOOT STONE ONLY	□ MONUMENT
↑ WITH HEAD AND FOOT STONES	
↑↑ HEAD STONE FOR TWO GRAVES	

SEE SECTION E DRAWING #5

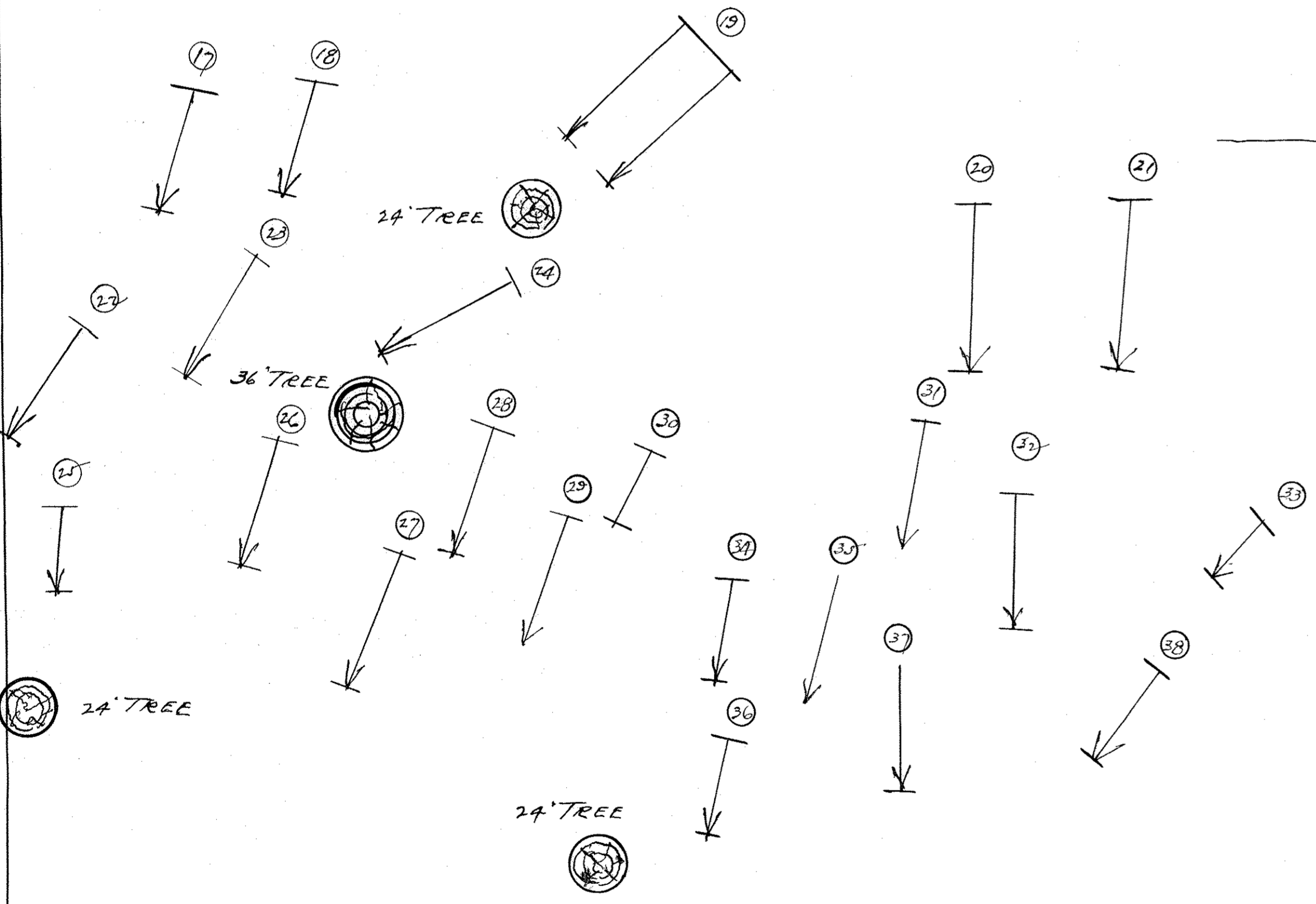

SEE SECTION C
DRAWING #3

SECTION PLAN SHOWING LOCATION
OF PLOTS AND GRAVES
(ALSO SEE CEMETERY INDEX)
DEVELOPED FOR THE TOWN BOARD
BY
THE INDUSTRIAL AID BUREAU OF
THE TOWN OF BEDFORD N.Y.
EXECUTED BY
R. R. POWELL L. M. MERES.
MAY - 1933

SECTION "D"

DRAWING NO 4